

2	ADHESIVE Tape	TESA #4972
1	COVER	SUS304 t=0.2mm
No	Description	MATERIAL

TOL ±	M1	M2	S1	S2	P1	P2	C	USR	MODEL	DESCRIPTION
0~6	.07	0.1	0.15	0.2	.05	0.1	0.5			CFast Type I Stainless Cover ASS'Y
6~30	0.1	0.2	0.25	0.3	0.2	0.4	2		DATE	2008.08.25
30~80	.15	0.25	0.2	0.3	0.2	0.4	2		DRN	MAX
80~180	.15	0.3	0.25	0.45	0.4	0.8	3		CKD	
180~315	0.2	0.5	0.4	0.6	0.6	1.2	3		APPD	VIC
315~800	0.3	0.8	0.7	1.1	0.8	1.5	4			
ANG. TOL ±	0°~30°	0.2°	30°~60°	0.5°	60°~90°	1°				

EVERTRON

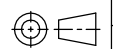

DIM MM
SIZE A4

MARK	REV	DESCRIPTION	SIGN	DATE
△	1.1	NOTE	MAX	05/10

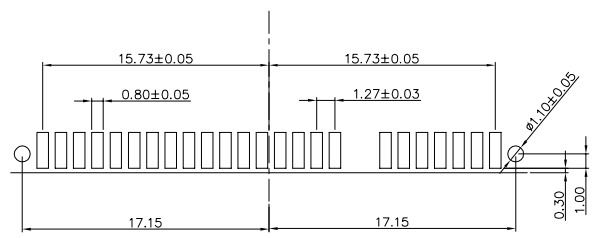
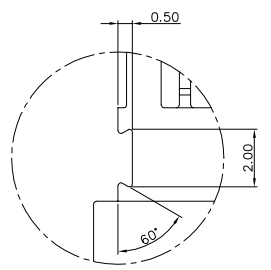
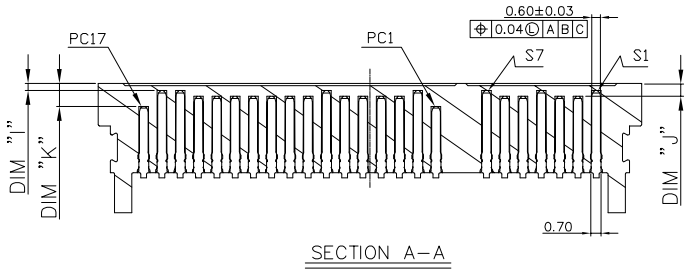
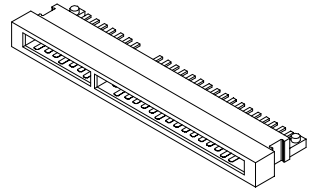

Recommended P.C.B. Layout

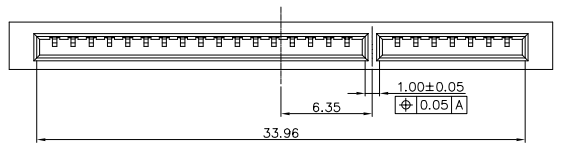
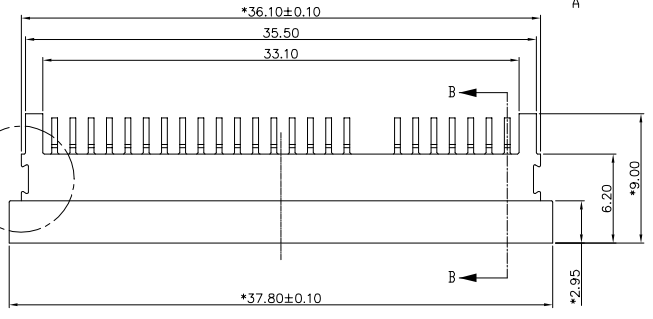
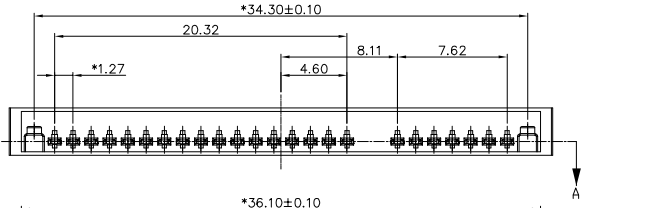

DETAIL C
SHEET 2/1

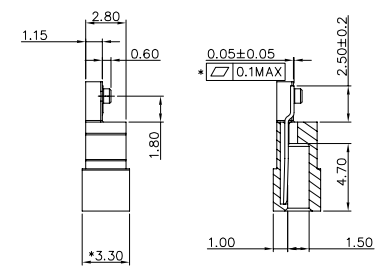

SECTION B-B

NOTE:

- MATERIAL:
1-1 HOUSING: LCP E4711 LCP 60% Glassfiber 20% Inorganic filler and other 20%, UL 94V-0, BLACK COLOR.
1-2 CONTACTS: PHOSPHOR BRONZE, C2680R-H.
- PLATING:
2-1 UNDERPLATE: 1.27μm (50μ") NICKEL.
2-2 CONTACT AREA: GOLD PLATING IN CONTACT AREA, 0.381μm [15μ"] MIN.
△2-3 SOLDER TAIL AREA: MATTE-TIN IN SOLDERING ZONE, WITH ENTIRE CONTACT UNDERPLATED 3.048μm [120μ"] MIN.
- PACKAGING: TRAY PACKAGE
- USING ALL MATERIAL TO ACCORD WITH RoSH CODE.
- Board Mounting Option: SMT
Insulator Material: Plastic
Min. Oper Temp.(C): -25°C
Max. Oper Temp.(C): 85°C
Mounting Option(1): SMT
Mounting Option(2): N/A
Terminal Type: Blade On Beam
Voltage Rating (V): 30 V
Current Rating: 1.5 Ampere per contact
Current Resistance: 30mΩ MAX

DIM #	PIN #
DIM "I"	0.5±0.1
DIM "J"	0.9±0.1
DIM "K"	1.6±0.1

TOL±	M1	M2	S1	S2	P1	P2	C	USR	MODEL	DESCRIPTION
RANGE	0~6	.05	0.1	0.15	0.2	.05	.01	0.5		Cfast Connector 7+17 Pin typeI
	6~30	0.1	0.2	0.15	0.25	0.1	0.15	1	DATE	2008.08.26
	30~80	.15	0.25	0.2	0.3	0.2	0.4	2	DRN	MAX
	80~180	.15	0.2	0.25	0.45	0.4	0.8	3	CKD	
	180~315	0.2	0.5	0.4	0.6	0.6	1.2	3	APPD	VIC
	315~800	0.3	0.8	0.7	1.1	0.8	1.5	4		
ANG. TOL±	0°~30°	0.2°	30°~60°	0.5°	60°~90°	1°				

EVERTRON

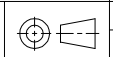

DIM MM
SIZE A4

1. STANDARD PACKAGE: 40 PCS / TRAY
2. 25 TRAY/PACKS CARTON
3. 4 PACKS CARTON / SHIPPING CORTON

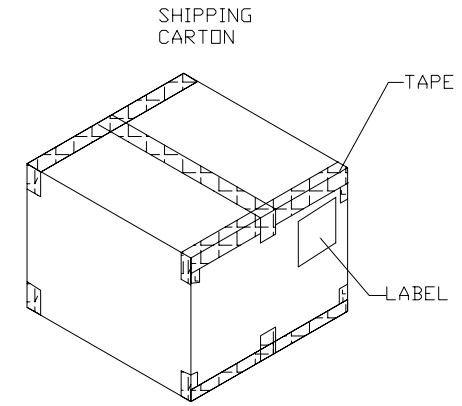
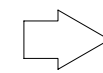
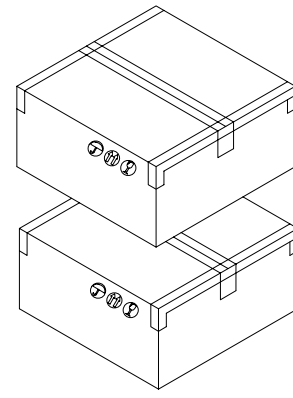
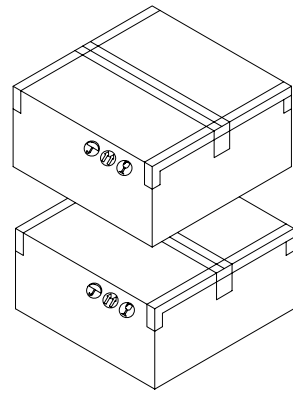
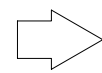
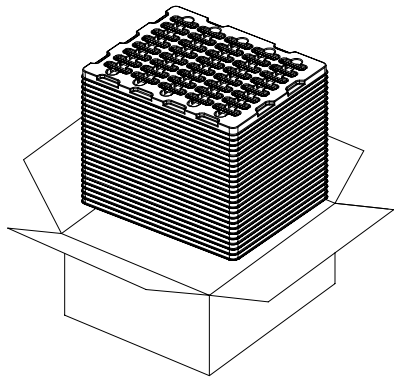
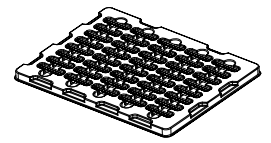

350mm x 350mm x 240mm

TOL ±										MODEL	DESCRIPTION			
RANGE	M1	M2	S1	S2	P1	P2	C	USR		DATE	DWG NO.	REV	1.0	
0~6	.05	0.1	0.15	0.2	.05	0.1	0.5			DRN	P/N NO.	SCALE	1/1	
6~30	0.1	0.2	0.15	0.25	0.1	0.15	1			CKD	<div style="text-align: center; font-weight: bold; font-size: 1.2em;">EVERTRON</div>			
30~80	.15	0.25	0.2	0.3	0.2	0.4	2			APPD				DIM
80~180	.15	0.3	0.25	0.45	0.4	0.8	3				SIZE	A4		
180~315	0.2	0.5	0.4	0.6	0.6	1.2	3							
315~800	0.3	0.8	0.7	1.1	0.8	1.5	4							
ANG. TOL ±	0°~30°	0.2°	30°~60°	0.5°	60°~90°	1°								